

ALUMINUM ELECTROLYTIC CAPACITORS

UPA Miniature Sized, Low Impedance, High Reliability For Switching Power Supplies



- Lower impedance than UPW.
- Smaller case size and high ripple current.
- Compliant to the RoHS directive (2011/65/EU,(EU)2015/863).



Specifications

Item	Performance Characteristics						
Category Temperature Range	-55 to +105°C						
Rated Voltage Range	6.3 to 35V						
Rated Capacitance Range	180 to 10000µF						
Capacitance Tolerance	±20% at 120Hz, 20°C						
Leakage Current	After 1 minute's application of rated voltage at 20°C, leakage current is not more than 0.03CV or 4 (µA), whichever is greater.						
Tangent of loss angle (tan δ)	Rated voltage (V)	6.3	10	16	25	35	120Hz 20°C
	tan δ (MAX.)	0.22	0.19	0.16	0.14	0.12	
For capacitance of more than 1000µF, add 0.02 for every increase of 1000µF.							
Stability at Low Temperature	Rated voltage (V)	6.3	10	16	25	35	120Hz
	Impedance ratio (MAX.) Z-55°C / Z+20°C	3	3	3	3	3	
Endurance	The specifications listed at right shall be met when the capacitors are restored to 20°C after D.C. bias plus rated ripple current is applied for 5000 hours (3000 hours for φD=8, 4000 hours for φD=10) at 105°C, the peak voltage shall not exceed the rated voltage.						
	Capacitance change	Within ±20% of the initial capacitance value (6.3V, 10V : ±30%)					
	tan δ	200% or less than the initial specified value (6.3V, 10V : 300%)					
Shelf Life	After storing the capacitors under no load at 105°C for 1000 hours and then performing voltage treatment based on JIS C 5101-4 clause 4.1 at 20°C, they shall meet the specified values for the endurance characteristics listed above.						
	Leakage current	Less than or equal to the initial specified value					
Marking	Printed with white color letter on dark brown sleeve.						

Radial Lead Type

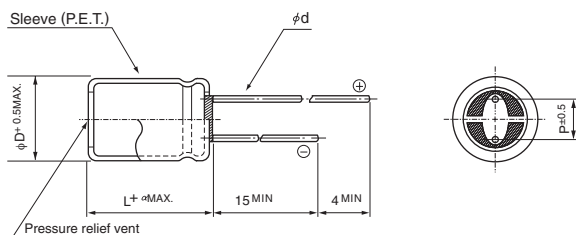

α	(L < 20)	1.5
	(L ≥ 20)	2.0

	(mm)				
φD	8	10	12.5	16	18
P	3.5	5.0	5.0	7.5	7.5
φd	0.6	0.6	*0.6	0.8	0.8

※ : In case L > 25 for the φ12.5 dia. unit, lead dia. φd = 0.8mm.

Type numbering system (Example : 10V 470µF)

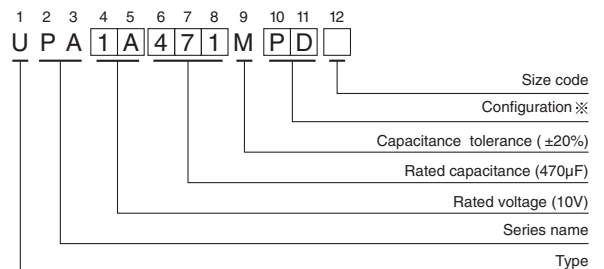

※ Configuration

φD	Pb-free leadwire Pb-free PET sleeve
8 · 10	PD
12.5 to 18	HD

Frequency coefficient of rated ripple current

Cap. (µF)	Frequency				
	50Hz	120Hz	300Hz	1kHz	10kHz or more
180 to 330	0.55	0.65	0.75	0.85	1.00
390 to 1000	0.70	0.75	0.80	0.90	1.00
1200 to 10000	0.80	0.85	0.90	0.95	1.00

• Please refer to page 20 about the end seal configuration.

Please refer to page 20, 21, 22 about the formed or taped product spec.
Please refer to page 4 for the minimum order quantity.

• Dimension table in next page.

Mouser Electronics

Authorized Distributor

Click to View Pricing, Inventory, Delivery & Lifecycle Information:

Nichicon:

[UPA0J102MPD](#) [UPA0J103MHD](#) [UPA0J152MPD](#) [UPA1A392MHD](#) [UPA0J122MPD](#) [UPA1A152MPD](#)
[UPA1A182MPD](#) [UPA1A222MPD](#) [UPA1A332MHD](#) [UPA1A471MPD](#) [UPA1A472MHD](#) [UPA1A561MPD](#)
[UPA1A562MHD](#) [UPA1A682MHD](#) [UPA1A821MPD](#) [UPA1A272MHD](#) [UPA0J561MPD](#) [UPA0J222MPD](#) [UPA0J272MPD](#)
[UPA0J332MHD](#) [UPA1A122MPD](#) [UPA0J472MHD](#) [UPA0J562MHD](#) [UPA0J681MPD](#) [UPA0J682MHD](#)
[UPA0J822MHD](#) [UPA1A102MPD](#) [UPA1A822MHD](#) [UPA1C682MHD](#) [UPA1C821MPD](#) [UPA1E102MPD](#)
[UPA1E122MHD](#) [UPA1C681MPD](#) [UPA1E222MHD](#) [UPA1E271MPD](#) [UPA1E331MPD](#) [UPA1E391MPD](#)
[UPA1E471MPD](#) [UPA1E182MHD](#) [UPA1C332MHD](#) [UPA1C102MPD](#) [UPA1C122MPD](#) [UPA1C152MPD](#)
[UPA1C222MHD](#) [UPA1C331MPD](#) [UPA1E332MHD](#) [UPA1C391MPD](#) [UPA1C392MHD](#) [UPA1C471MPD](#)
[UPA1C472MHD](#) [UPA1C562MHD](#) [UPA1C272MHD](#) [UPA1V391MPD](#) [UPA1V561MPD](#) [UPA1V681MPD](#)
[UPA1E472MHD](#) [UPA1V332MHD](#) [UPA1E272MHD](#) [UPA1E821MPD](#) [UPA1E561MPD](#) [UPA1E681MPD](#)
[UPA1V102MHD](#) [UPA1V122MHD](#) [UPA1V152MHD](#) [UPA1V271MPD](#) [UPA1V272MHD](#) [UPA1V222MHD](#)
[UPA1V182MHD](#) [UPA1V181MPD](#) [UPA1A222MHD6](#) [UPA1E102MHD6](#) [UPA1V821MPD](#) [UPA1C472MHD6TN](#)
[UPA1A821MPD1TD](#) [UPA1A122MPD1TD](#) [UPA1E332MHD1TN](#) [UPA1V391MPD1TD](#) [UPA1E182MHD1TO](#)
[UPA0J222MPD6TD](#) [UPA1C391MPD1TD](#) [UPA1V561MPD1TD](#) [UPA1C681MPD6TD](#) [UPA1E561MPD6TD](#)
[UPA1A182MPD1TD](#) [UPA1A222MHD6TO](#) [UPA1C222MHD6TO](#) [UPA0J822MHD1TN](#) [UPA1V271MPD1TD](#)
[UPA0J152MPD1TD](#) [UPA0J332MHD1TO](#) [UPA1V272MHD6TN](#) [UPA1A471MPD1TD](#) [UPA1V102MHD1TO](#)
[UPA1E561MPD1TD](#) [UPA1C102MPD6TD](#) [UPA0J561MPD1TD](#) [UPA1E471MPD6TD](#) [UPA1E681MPD1TD](#)
[UPA1V681MPD1TD](#) [UPA1C122MPD1TD](#)